

## SCHEDA TECNICA PRODOTTO

### TECHNICAL DATASHEET



PALO IN SEZIONE A 'T' PER RECINZIONE IN ACCIAIO PLASTIFICATO COLORE VERDE SCURO RAL 6005

'T'-SHAPE POST FOR FENCE MADE BY STEEL WIRE PVC COATED DARK GREEN RAL 6005

### Caratteristiche tecniche – Technical features

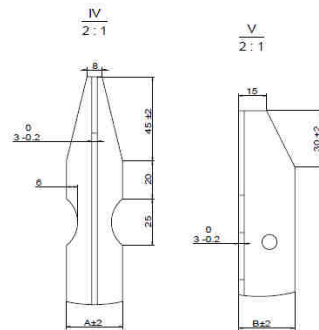
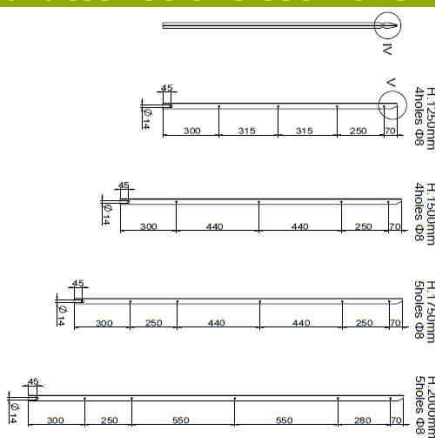

Pali per recinzioni realizzati in acciaio profilato a 'T' e plastificati.  
Sezioni: 30x30x3,0 mm e 35x35x3,5 mm  
Altezze: da 1,25 a 3,00 m  
Disponibili altre misure su richiesta

PVC coated 'T'-shape posts for fences  
Size : 30x30x3,0 mm & 35x35x3,5 mm  
Height: from 1,25 to 3,00 m  
Available in different sizes and mesh on demand

### Descrizione articolo – Article description

#### Palo a 'T' per recinzione in acciaio – 'T'-shape steel fence post

Codice prodotto	Finitura	Profilo a 'T' mm	Altezza cm	Peso Kg	Packing pz/pallet (pacchi/pallet)	Note
Item code	Finishing	'T' profile shape mm	Height cm	Weight Kg	Packing min unit (min unit/pallet)	Remarks
NET1-192/3030V/125	PVC RAL 6005	30x30x3,0	125	1,70	10 pz x 40	
NET1-192/3030V/150	PVC RAL 6005	30x30x3,0	150	2,00	10 pz x 40	
NET1-192/3030V/175	PVC RAL 6005	30x30x3,0	175	2,30	10 pz x 40	
NET1-192/3030V/200	PVC RAL 6005	30x30x3,0	200	2,70	10 pz x 20	
NET-192/3535V/200	PVC RAL 6005	35x35x3,5	200	3,70	10 pz x 20	
NET-192/3535V/225	PVC RAL 6005	35x35x3,5	225	4,10	10 pz x 20	
NET-192/3535V/250	PVC RAL 6005	35x35x3,5	250	4,60	10 pz x 20	
NET-192/3535V/300	PVC RAL 6005	35x35x3,5	300	5,50	10 pz x 20	*

\* Disponibile su richiesta / Available upon request

Rivestimento PVC considerato in accordo con le linee guida del Regolamento "REACH" 1907/2006/CE.  
PVC coating complying with guidelines "REACH" Regulation 1907/2006/CE.